









Map Key

-  Restroom
-  Family Restroom with Adult Changing Station
-  Public Hallways
-  Elevator
-  Stairs
-  Information Desk
-  Check-In Desk
-  Conference Room

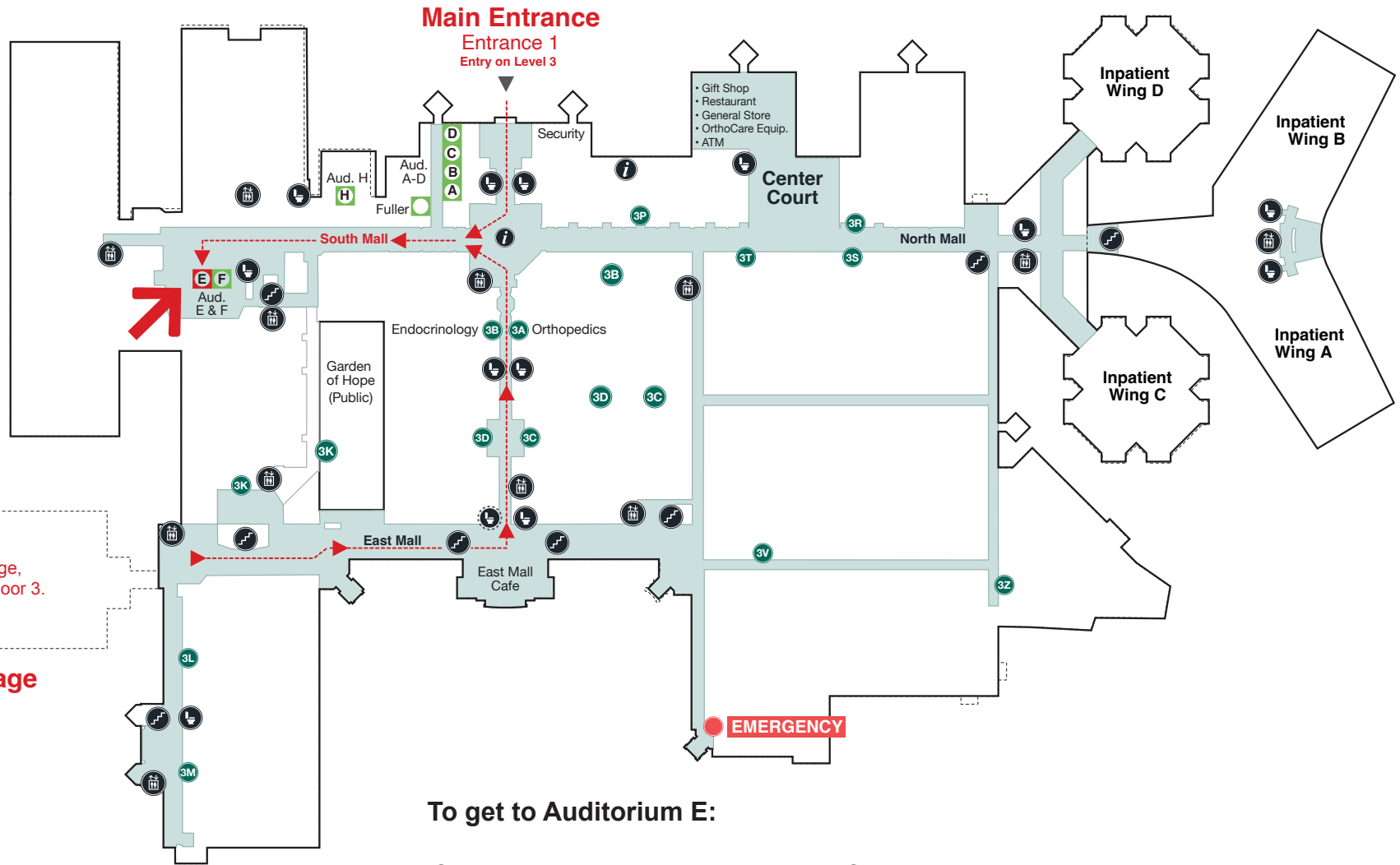

If parking in garage, take elevator to floor 3.

Parking Garage
Entrance 4
Entry on Level 4

To get to Auditorium E:

If you park at the main entrance of the Hospital:

- Enter the hospital and approach the information desk.
- Turn right to proceed down the South Mall.
- Auditorium E will be on your left.

If you park in the garage:

- Enter the hospital and take the stairs or elevator to the third floor.
- Head toward the East Mall Cafe, then turn left down the hall toward the main hospital entrance. (You'll pass the reception areas for 3D, 3C, 3B, and 3A.)
- As you approach the main entrance, turn left at the information desk and head down the South Mall corridor.
- Auditorium E will be on your left.

**Dartmouth-Hitchcock
Medical Center
1 Medical Center Drive
Lebanon, NH 03766**